



TOOLFLEX®

Backlash-free, torsionally stiff and maintenance-free coupling



Type S with setscrew



Type M with setscrew



Type S with clamping hubs



Type M with clamping hubs



Type KN (Taper hubs)



Type PI



Type CF



1 Technical data

Type S with clamping hubs

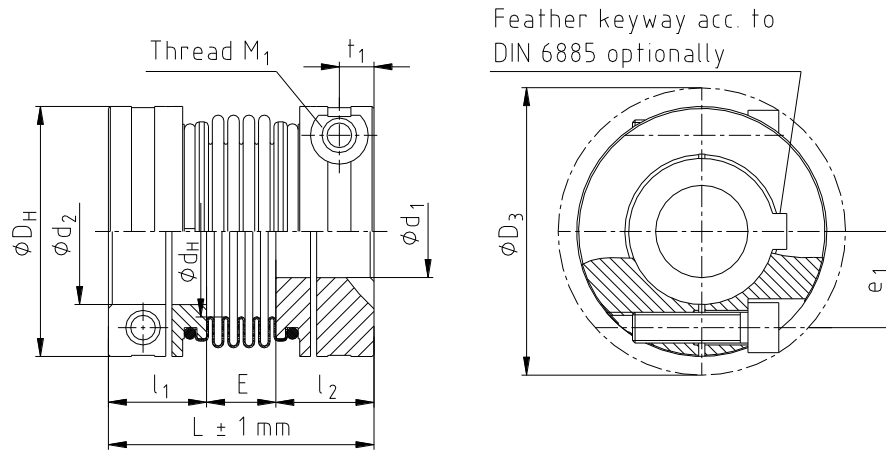

Illustration 3: TOOLFLEX® type S with clamping hubs

Table 2: Dimensions - type S (4 layers) with clamping hubs

Hub material: aluminium (hub size 55 and 65: steel); bellow material: stainless steel												
Size	Dimensions [mm]											
	Finish bore		General					Clamping screws DIN EN ISO 4762				
	Min. d	Max. d	L	l ₁ , l ₂	E	D _H	d _H	M ₁	D ₃	t ₁	e ₁	T _A [Nm]
7	3	7	24.0	9.0	6.0	15	9	M2	16.5	3.2	5.0	0.37
9	3	9	29.0	11.0	7.0	20	12	M2.5	21.5	3.5	7.1	0.76
12	4	12	34.5	13.0	8.5	25	16	M3	26.5	4	8.5	1.34
16	5	16	45.0	17.0	11.0	32	20	M4	35.0	5	12.0	2.9
20	8	20	55.0	21.5	12.0	40	27	M5	43.5	6	14.5	6
30	10	30	63.0	23.0	17.0	55	33	M6	58.0	7	19.0	10
38	12	38	69.0	25.5	18.0	65	42	M8	72.6	9	25.0	25
42	14	42	84.0	30.0	24.0	70	46	M8	76.1	9	27.0	25
45	14	45	86.5	32.0	22.5	83	58	M10	89.0	11	30.0	49
55 ³⁾	20	55	111.0	40.0	31.0	100	73	M12	106.0	14	37.0	120
65 ³⁾	30	65	126.0	45.0	36.0	125	95	M14	127.2	15	45	185

Table 3: Technical data - type S (4 layers) with clamping hubs

Hub material: aluminium (hub size 55 and 65: steel); bellow material: stainless steel							
Size	Torque of bellow T _{KN} [Nm]	Speed n ¹⁾ [rpm]	Moment of inertia ²⁾ [x10 ⁻⁶ kgm ²]	Torsion stiffness C _T [Nm/rad]	Axial spring stiffness [N/mm]	Radial spring stiffness [N/mm]	Weight ²⁾ [kg]
7	1	31800	0.26	390	-	-	0.007
9	1.5	23800	0.97	750	-	-	0.014
12	2	19100	2.6	1270	-	-	0.025
16	5	14900	9	4500	43	138	0.06
20	15	11950	30	9600	63	189	0.12
30	35	8700	114	17800	97	233	0.24
38	65	7350	245	37400	108	318	0.35
42	95	6820	396	54700	120	499	0.49
45	170	5750	931	95800	132	738	0.8
55 ³⁾	340	4800	4996	144100	160	894	3.2
65 ³⁾	600	3850	13318	322740	212	1365	5.5

1) With v = 25 m/s

2) Figures refer to the complete coupling with max. bore.

3) Hubs made of steel welded with bellow.

Please observe protection note ISO 16016.	Drawn:	2019-07-16 Wih/Ki	Replacing:	KTR-N dated 2019-04-09
	Verified:	2019-07-19 Shg	Replaced by:	